



## FENCE PERMIT APPLICATION

This information is provided as a guide to assist you in the preparation of the application for a **Fence Permit**. It is also intended to explain the process by which the City analyzes and acts upon the application.

### Need a Fence Permit?

Any new fence or wall requires a fence permit. Repair of an existing fence does not require a permit, if the height and material of the fence does not change.

The allowed maximum height of the fence depends on its location on the property. Please refer to the table below for more information:

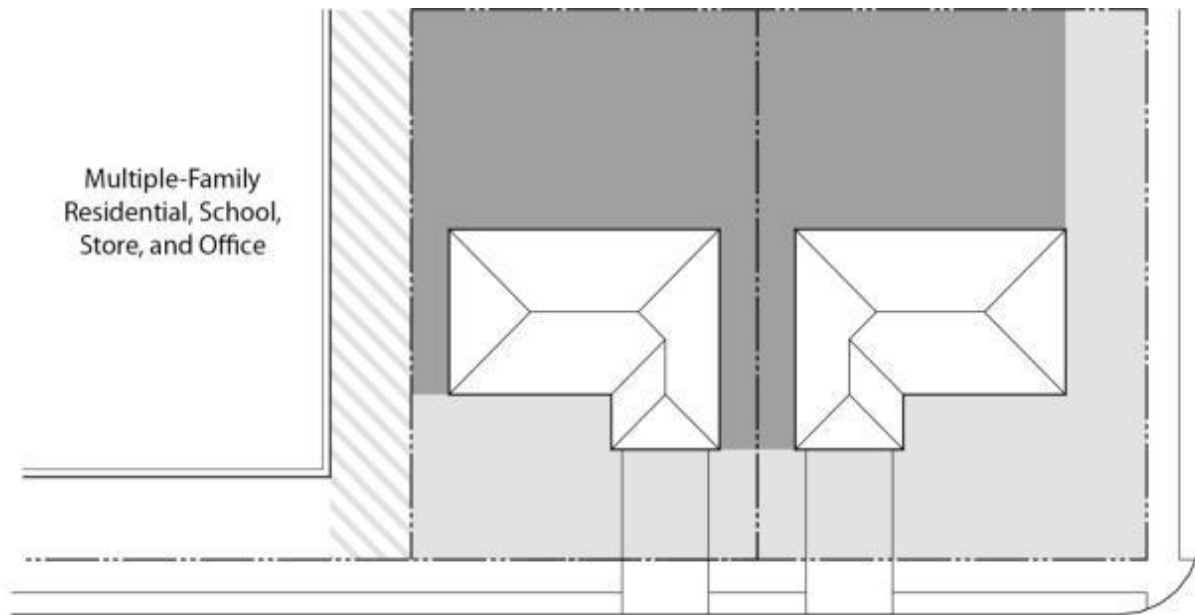

### Maximum Fence Height

8' \*      6'      3'-6" \*\*

\* Solid masonry fence required

\*\* All fences are required to have a minimum of 50% opacity. This will comply with the clear vision triangle required at intersections and driveways.

In areas where the six-foot maximum applies, the fence may extend an additional foot in height if topped with a decorative lattice to match the fence material.



Community Development Department  
1 Plaza, PO Box 667  
Patterson, CA 95363  
Ph. 209.895.8020  
Fax 209.895.8019  
[www.ci.patterson.ca.us](http://www.ci.patterson.ca.us)

## **Application Submittal**

An application for a fence permit shall be submitted to the Planning Department, 1 Plaza (P.O. Box 667), Patterson, CA 95363.

Additional information may be required by the Community Development Director and/or City Planner during the review of the application.

## **Building Permits**

Separate building permits are required prior to any construction. Building permits shall not be issued until the appeal period has expired or any appeals filed have been acted upon by the Planning Commission/City Council.



Community Development Department  
1 Plaza, PO Box 667  
Patterson, CA 95363  
Ph. 209.895.8020  
Fax 209.895.8019  
www.ci.patterson.ca.us

## Fence Permit Application

Application: # \_\_\_\_\_

\_\_\_\_\_  
Applicant Name

\_\_\_\_\_  
Mailing Address/City/State/Zip

\_\_\_\_\_  
Phone Number

\_\_\_\_\_  
Email

\_\_\_\_\_  
Property Owner

\_\_\_\_\_  
Mailing Address/City/State/Zip

\_\_\_\_\_  
Phone Number

\_\_\_\_\_  
Email

### **Explanation of Construction: Type of Material/Dimensions**

\_\_\_\_\_  
\_\_\_\_\_  
\_\_\_\_\_

### **SIGNATURES:**

The above information as well as the plans and materials submitted herewith in support of this application are, to the best of my/our knowledge, true and correct.

**APPLICANT:** \_\_\_\_\_ **DATE:** \_\_\_\_\_

**PROPERTY OWNER:** \_\_\_\_\_ **DATE:** \_\_\_\_\_